

Fort William Historic Images

Compiled by Dr Bess Rhodes

November 2020

Date: c. 1710

Plan of Fort
William with the
country adjacent.

By Robert
Johnson.

National Library of
Scotland, MS.1646
Z 02/24a.

Source: <https://maps.nls.uk/view/0002713>



A Plan of Fort William
with the Country adjacent,
A Scale of Feet to the Fort and Town
A Scale of Miles to the Country in



Date: c. 1710

Detail of Robert Johnson's plan (see previous image). Source: <https://maps.nls.uk/view/00002713>

Date: c. 1710

Plan of Fort William at Inverlochie.

By Theodore Dury.

National Library of Scotland, MS.1646 Z.02/24b.

Source: <https://maps.nls.uk/view/00002714>

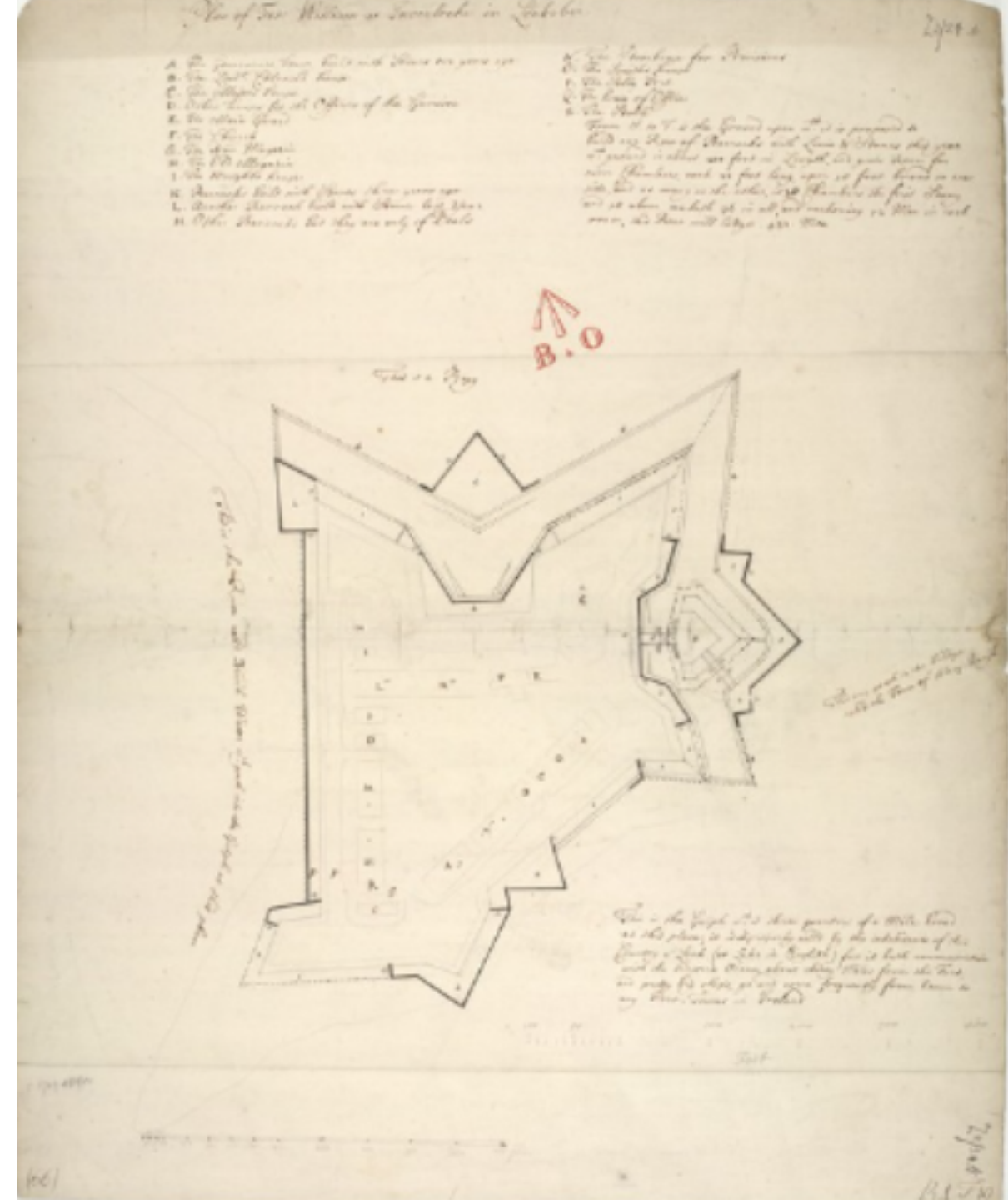

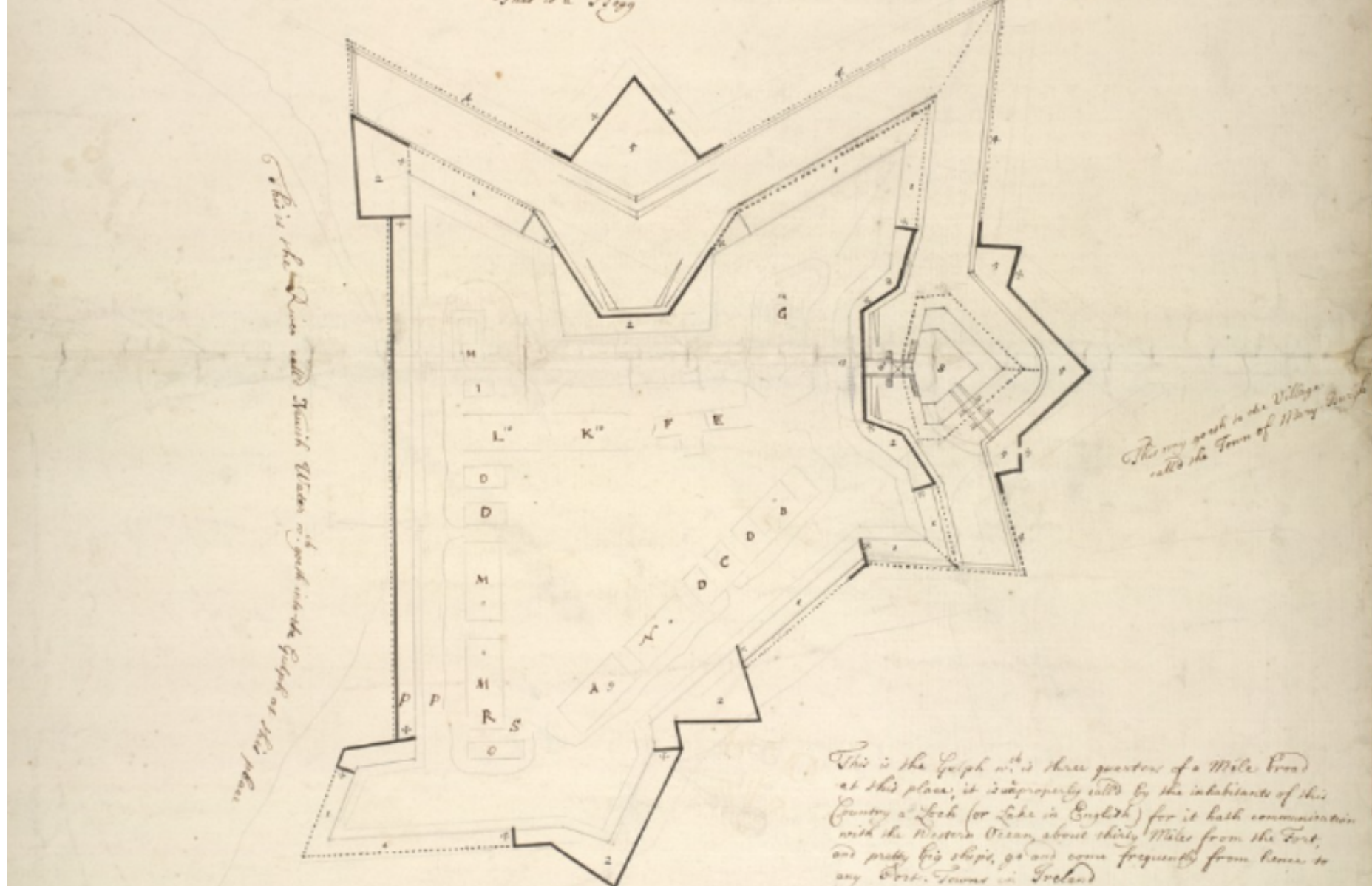

Date: c. 1710

Detail of Theodore Dury's plan (see previous image). Source: <https://maps.nls.uk/view/00002714>

Date: 1709

Plan of Fort William at Inverlochie in its present condition.

By Theodore Dury.

National Library of Scotland, MS.1646 Z.02/24c.

Source: <https://maps.nls.uk/view/00002715>

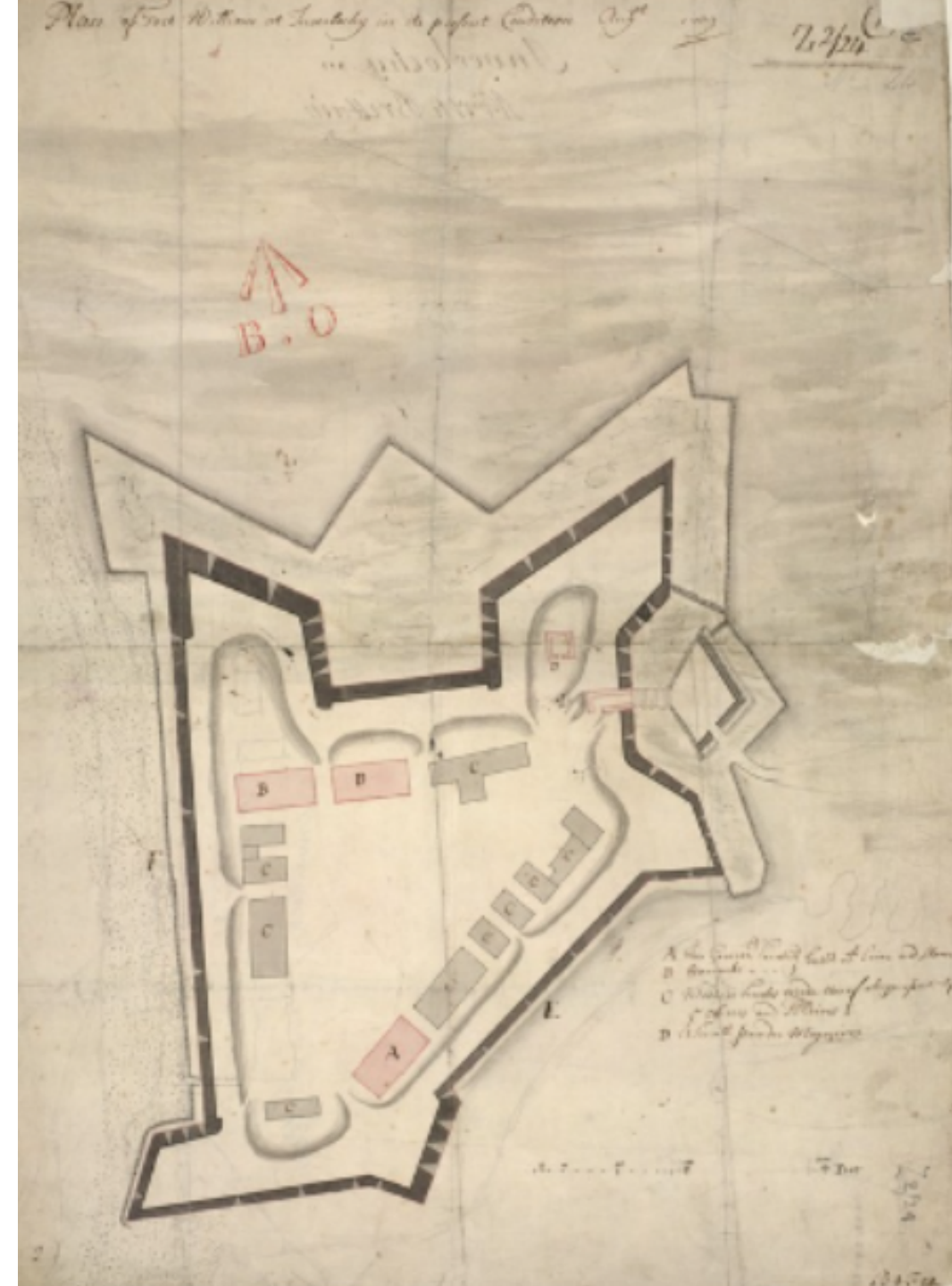

Date: 1712

The front of the
new store house,
built 1712, Fort
William.

By Lewis Petit.

National Library of
Scotland, MS.1646
Z.02/25a.

Source: <https://maps.nls.uk/view/00002709>

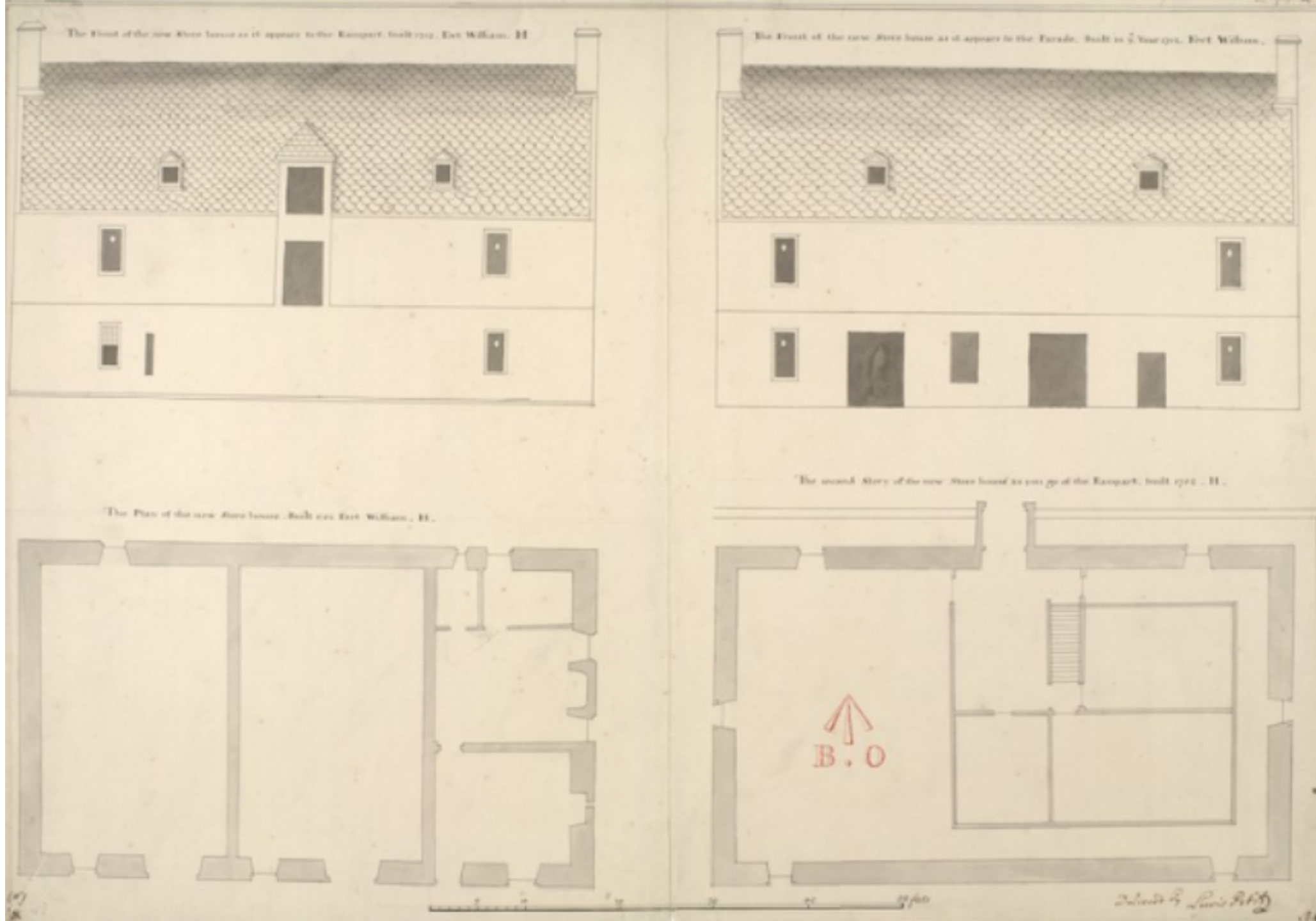

Date: 1712
Plans of the
Soldiers'
Barracks,
Fort William.
By Lewis
Petit.
National
Library of
Scotland,
MS.1646
Z.02/25b.
Source: <https://maps.nls.uk/view/00002710>

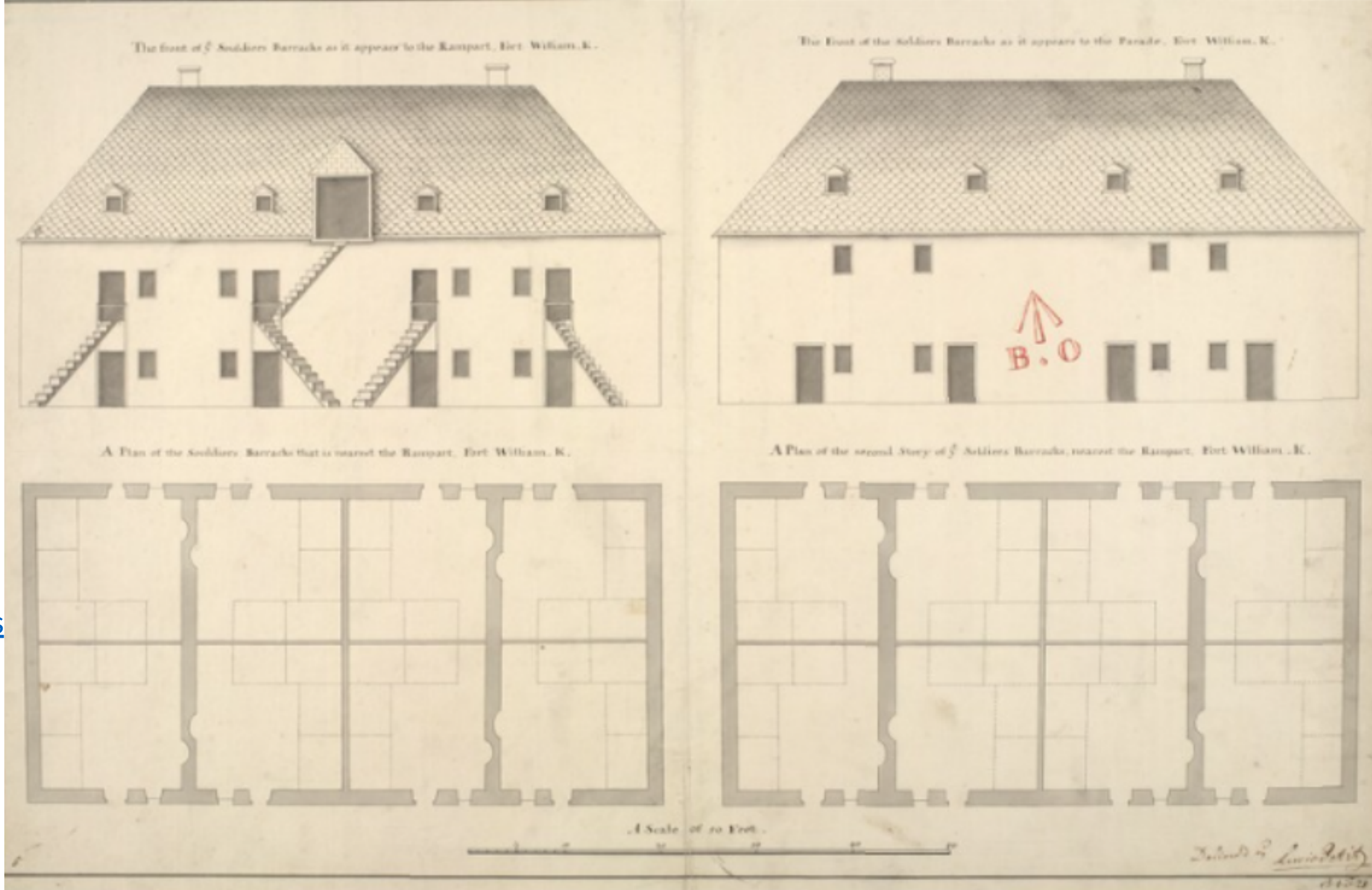

Date: 1719

Fort William, plan no.1.

By Andrews Jelfe and Thomas Moore.

National Library of Scotland,
MS.1646 Z.02/26a.

Source: <https://maps.nls.uk/view/00002719>

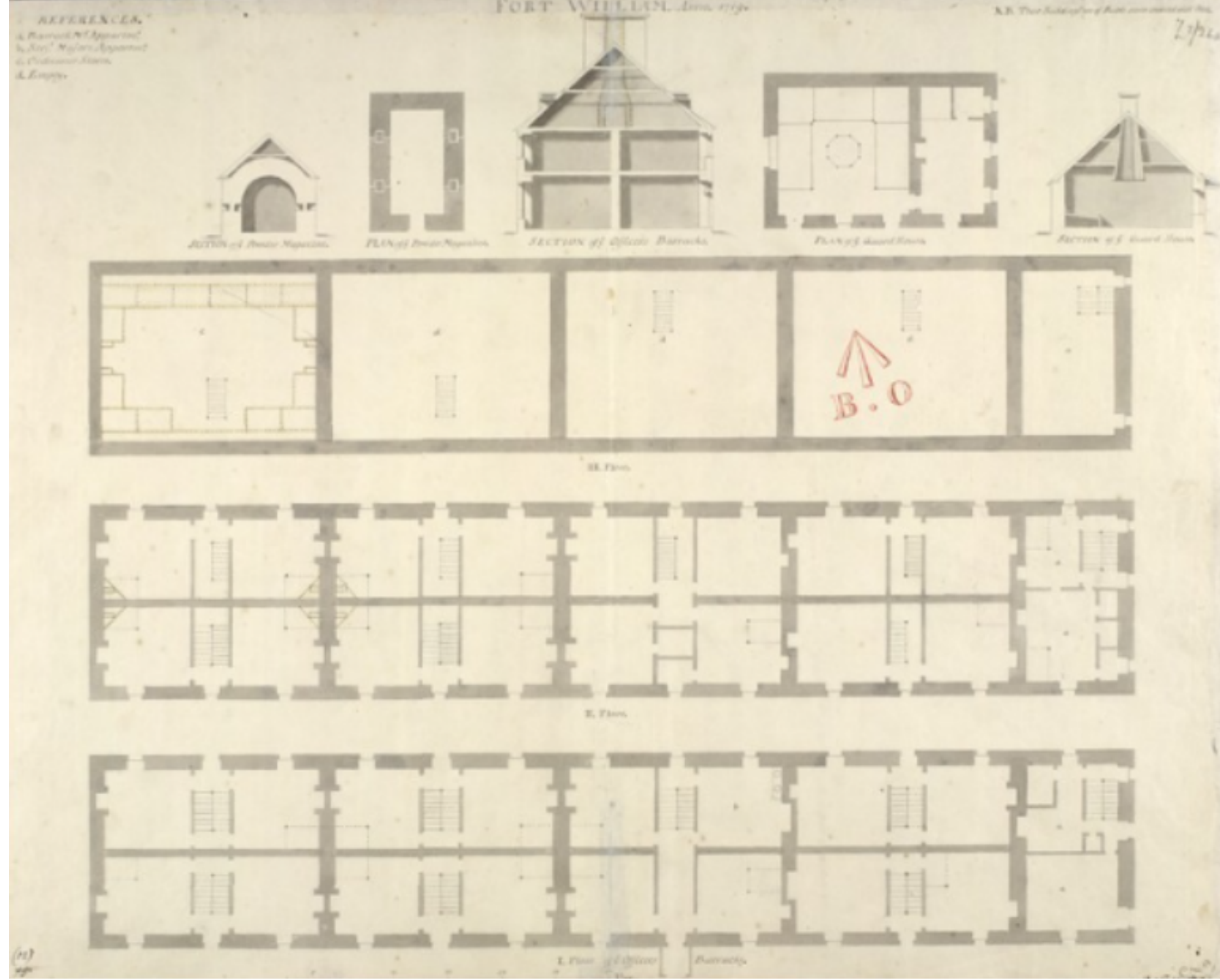

Date: 1719

Fort William, plan no.2.

By Andrews Jelfe and Thomas Moore.

National Library of Scotland,
MS.1646 Z.02/26c.

Source:
<https://maps.nls.uk/view/00002721>

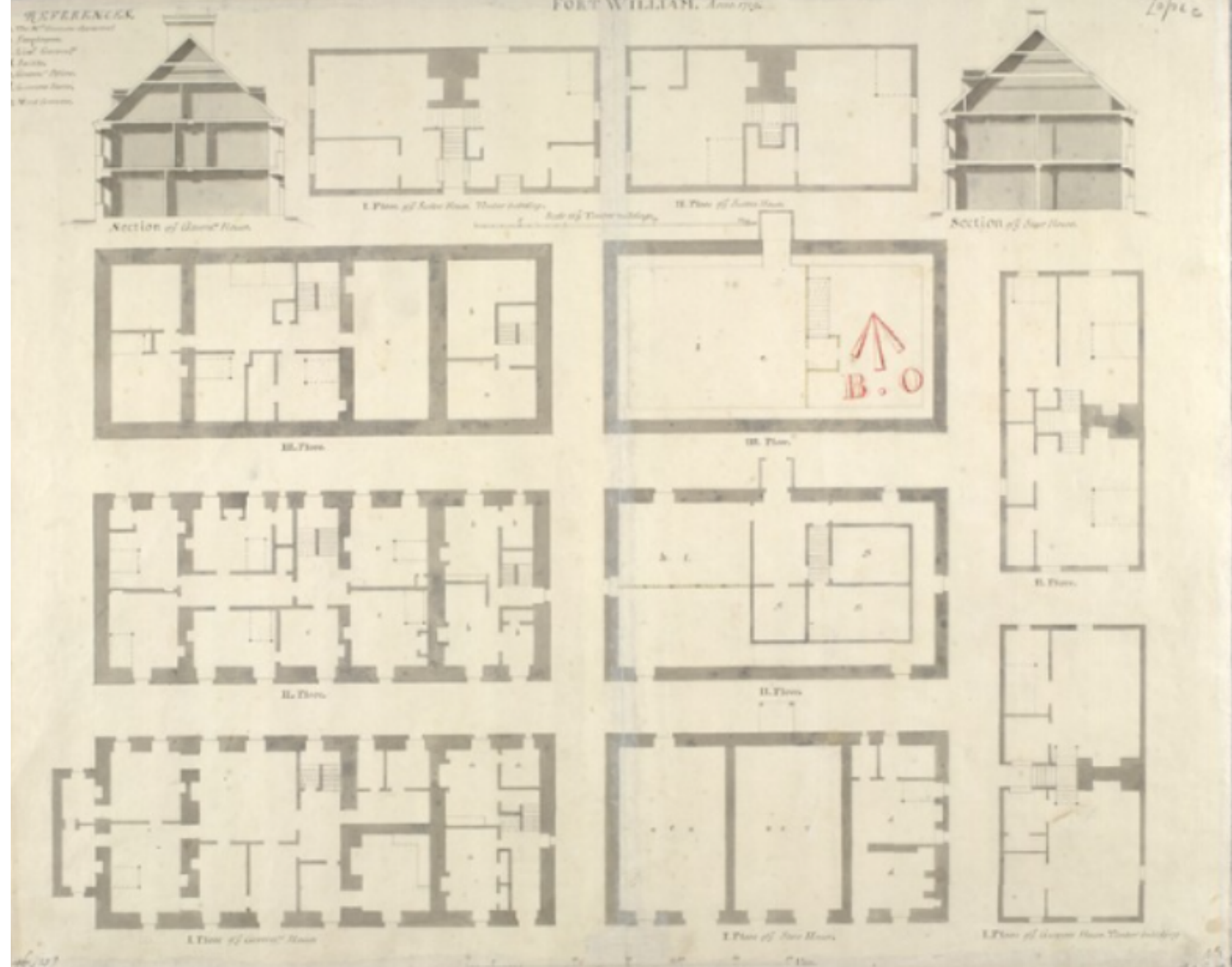

Date: 1728

Plan of district of Fort William.

By George Wade.

National Library of
Scotland, Acc.10497
Wade 581.

Source: <https://maps.nls.uk/view/00001157>





Date: 1728

Detail of George Wade's plan (see previous image). Source: <https://maps.nls.uk/view/00001157>

Date: c. 1736

Plan showing
fortifications at Fort
William and town of
Maryborough.

By George Wade.

National Library of
Scotland, Acc.10497
Wade 58.o.

Source: <https://maps.nls.uk/view/00001165>

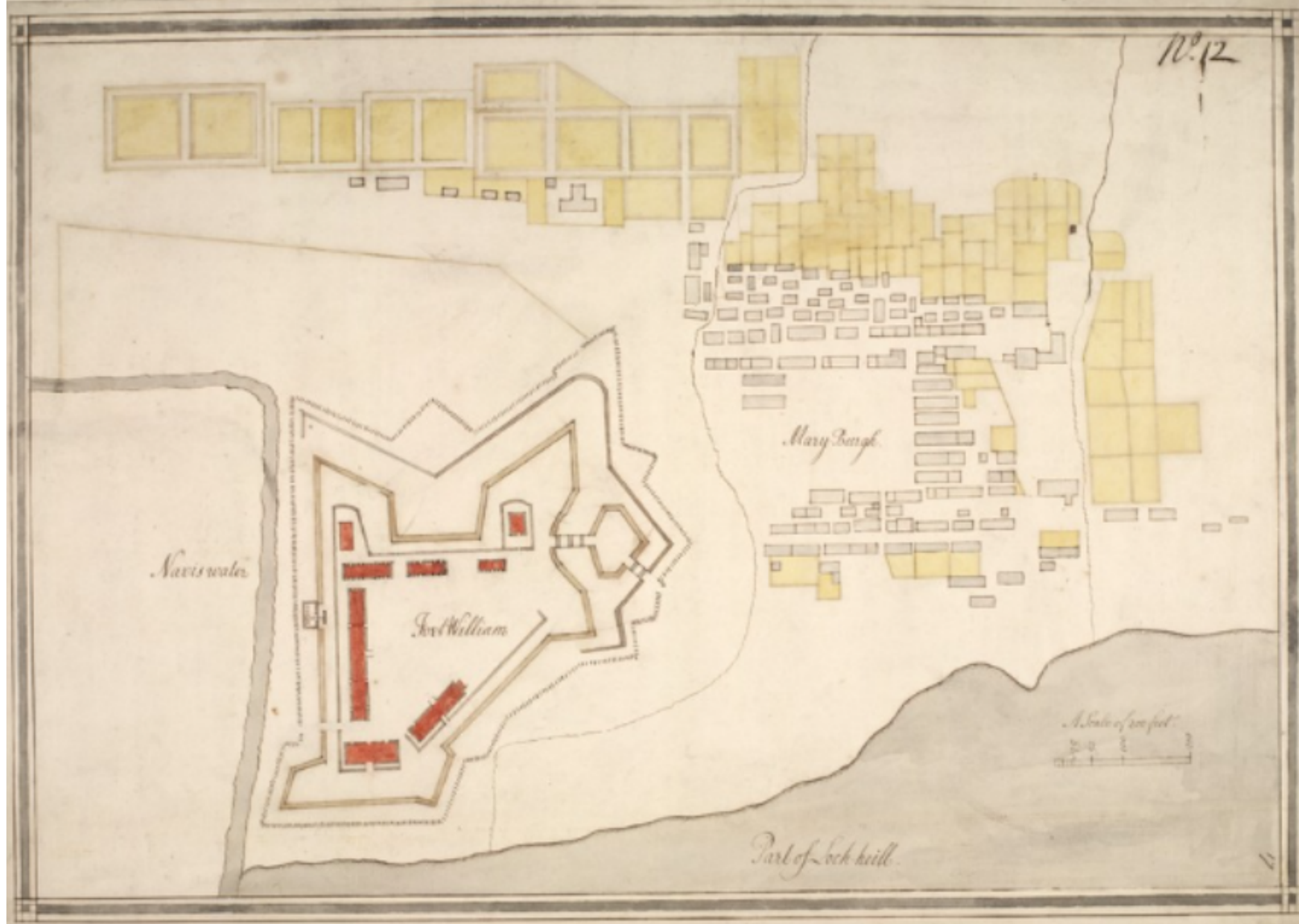

Date: 1736

**Plan of Fort William
and District.**

By George Wade.

**National Library of
Scotland, Acc.10497
Wade.58p.**

**Source: [https://maps
.nls.uk/view/000011
66](https://maps.nls.uk/view/00001166)**





Date: 1736

Detail of George Wade's plan of the district of Fort William (see previous image).

Source: <https://maps.nls.uk/view/00001166>

Date: 1744

Plan of the front entrance to Fort William.

By Dugal Campbell.

National Library of Scotland, MS.1646
Z.02/27a.

Source: <https://maps.nls.uk/view/00002725>

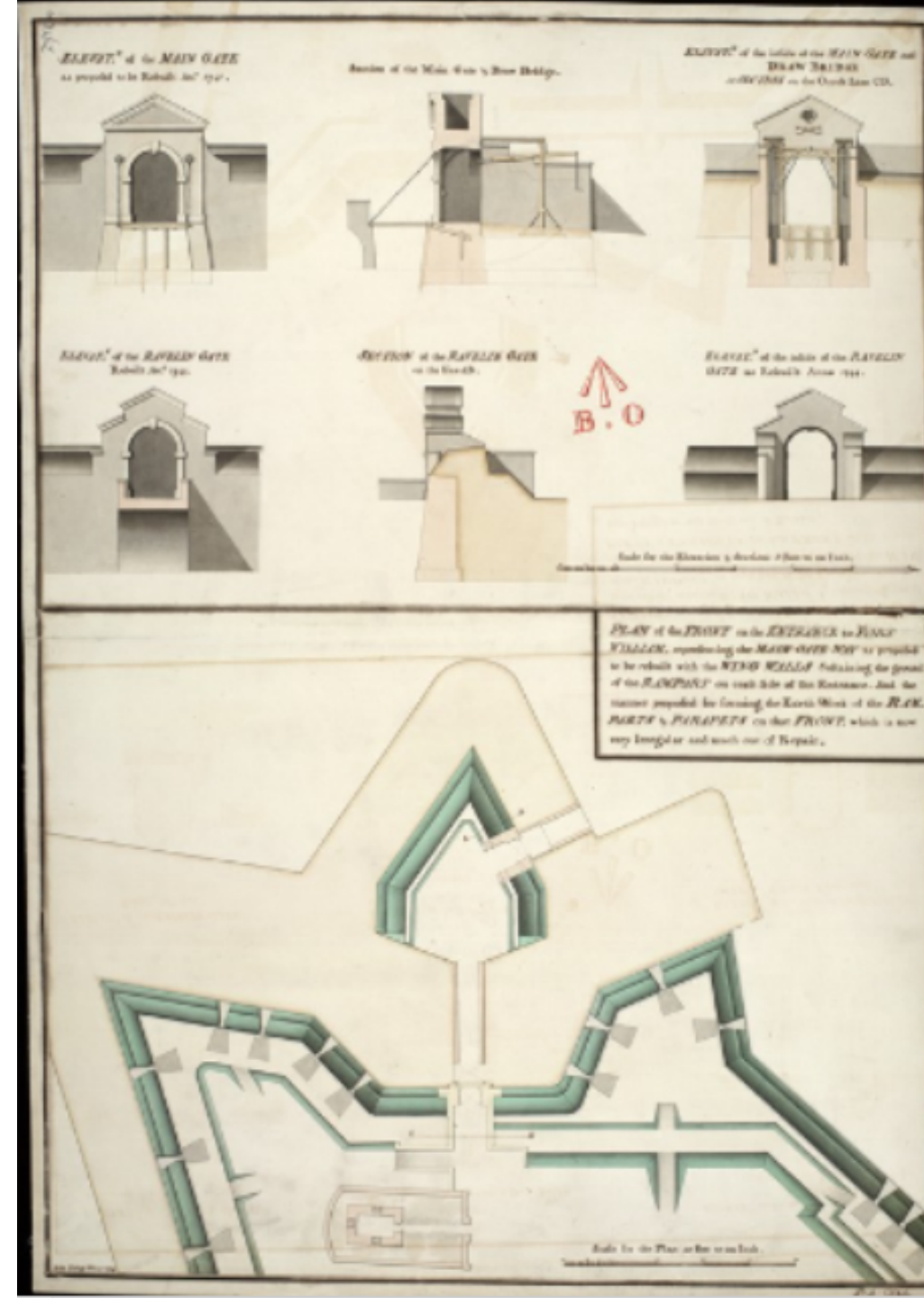

72/17

ELEVAT.ⁿ of the MAIN GATE

as proposed to be Rebuilt An.^o 1744.



Section of the Main Gate & Draw Bridge.

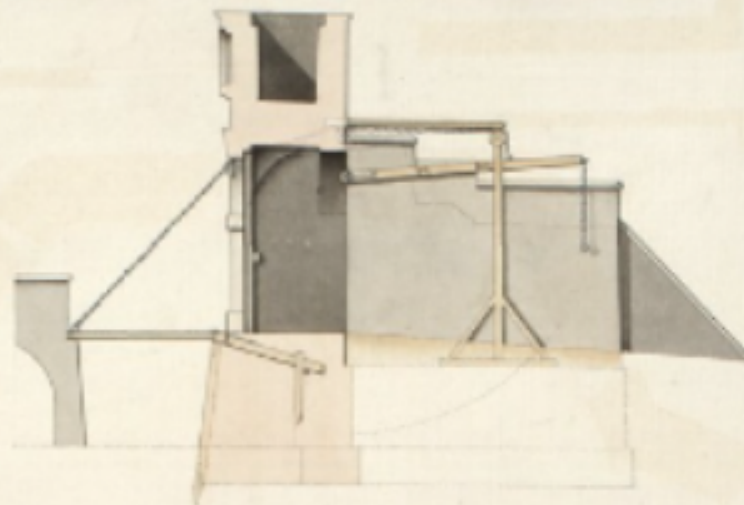

*ELEVAT.ⁿ of the inside of the MAIN GATE and
DRAW BRIDGE*

or SECTION on the Ocult Line CD.



ELEVAT.ⁿ of the RAVELIN GATE

Rebuilt An.^o 1744.



SECTION of the RAVELIN GATE

on the line AB.



ELEVAT.ⁿ of the inside of the RAVELIN

GATE as Rebuilt Anno 1744.



B.O.

Scale for the Elevation & Sections 3 Feet to an Inch.

Date: 1744

Detail of front entrance to Fort William by Dugal Campell (see previous image).

Source: <https://maps.nls.uk/view/00002725>

Date: 1744

Detail of plan of front entrance to Fort William by Dugal Campell (see earlier image).

Source: <https://maps.nls.uk/view/00002725>

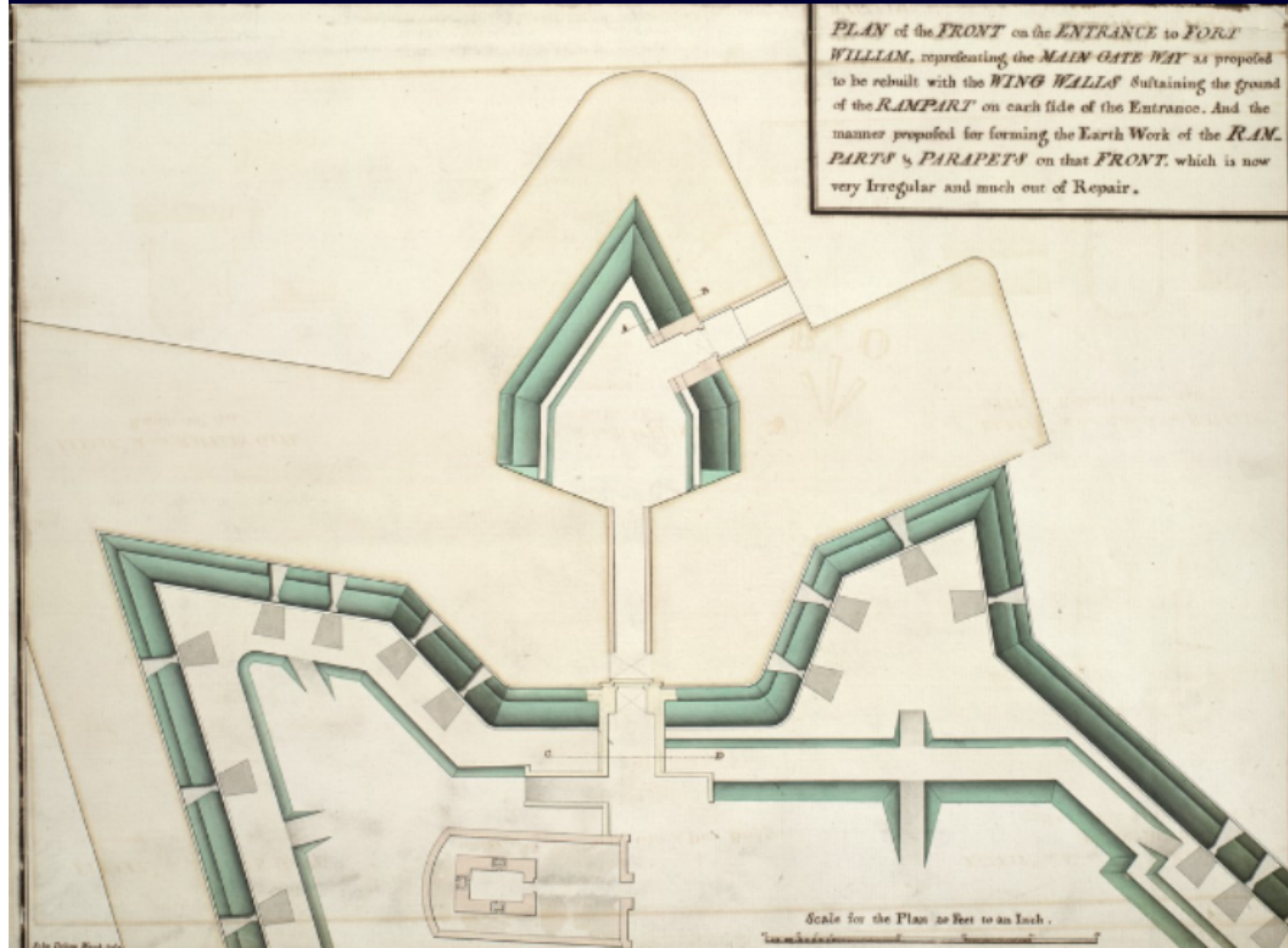

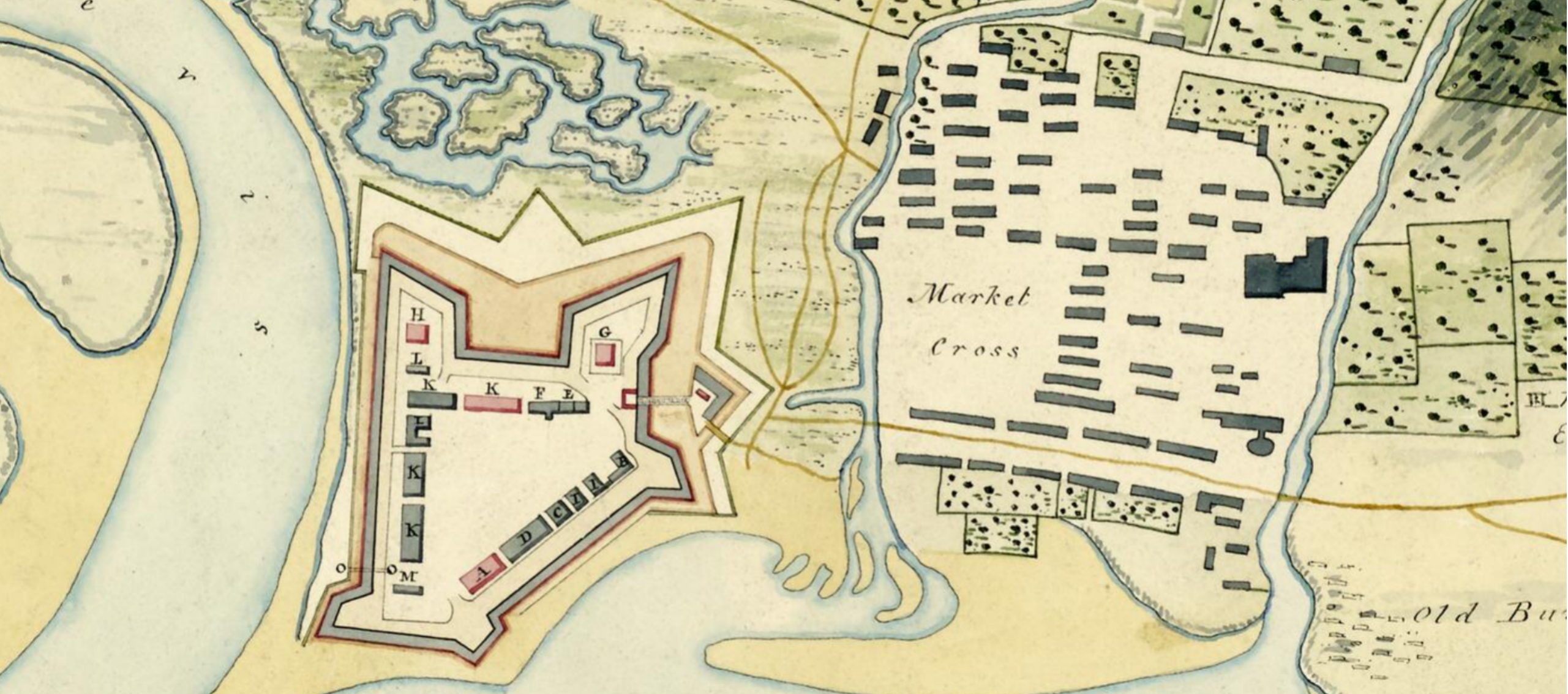

Date: c. 1800

Detail of c. 1800 plan of Fort William (see previous image).

Source: <https://canmore.org.uk/collection/1511609>



Date: September 1883

Photo of Fort William before demolition. By Esrkin Beveridge. Historic Environment Scotland, SC 746274.

Source: <https://canmore.org.uk/collection/746274>

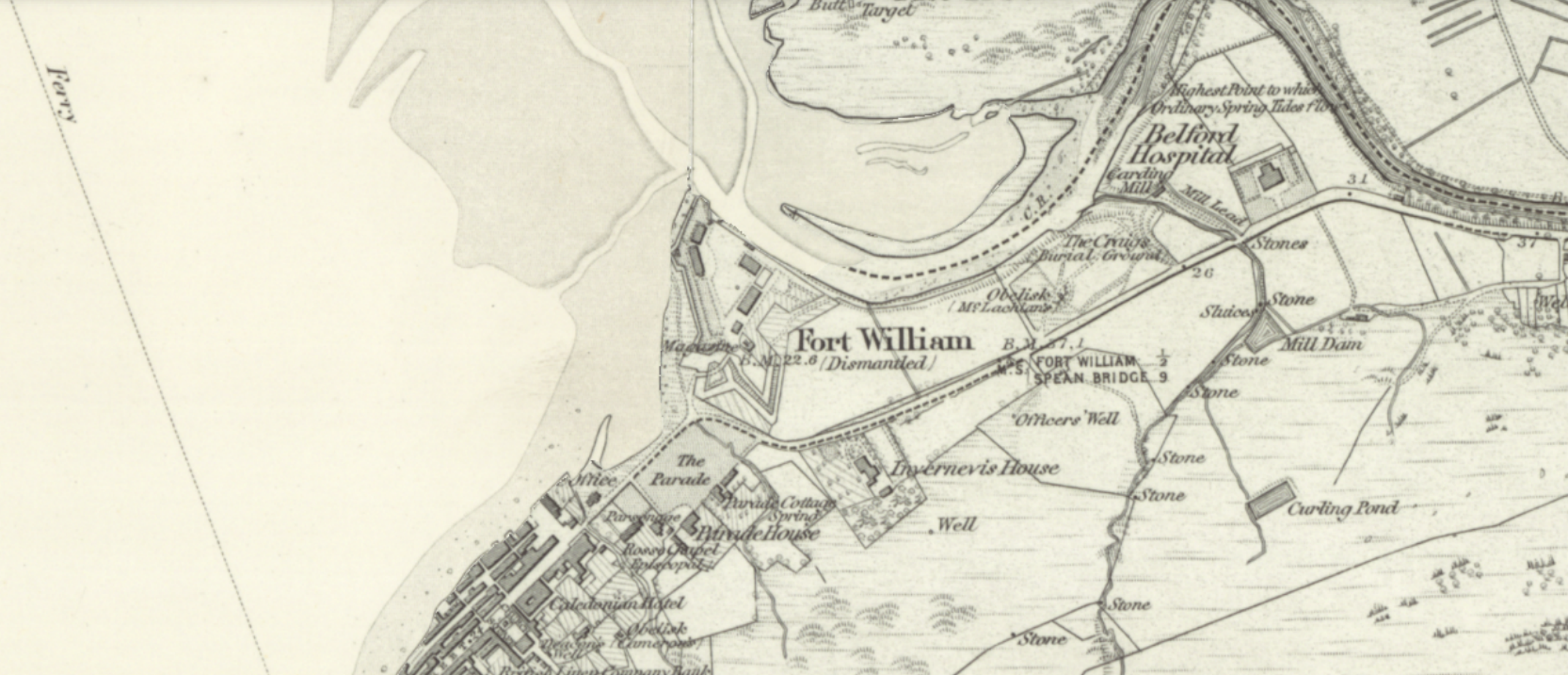

Date: 1843-1882

Ordnance Survey (6 inch). National Library of Scotland.

<https://maps.nls.uk/geo/explore/#zoom=15.999688411521513&lat=56.82087&lon=-5.10812&layers=5&b=1>



Date: c.2020. Approx. location of fort superimposed on aerial image of Fort William today.